

加防水圈示意图

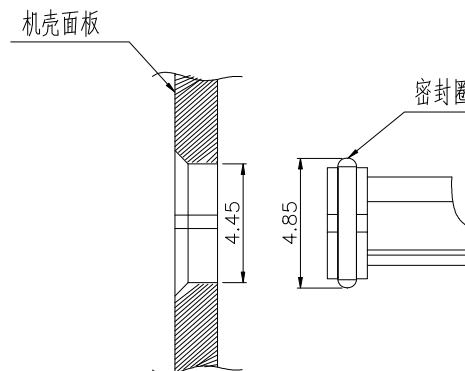

前后组装方式

Note:

1.Material:

- 1.1 Housing: PA9T
- 1.2 Contact:C7025,t=0.12mm middleclip SUS t=0.15mm
- 1.3 Shell: Zinc Alloy.

2.ELECTRICAL:

- 2-1:CURRENT RATING:
VBUS AND GND CONTACTS RATED AT 1.25A
PARALLELED FOR A TOTAL OF 3A;
- 2-2:INITIAL CONTACT RESISTANCE :40 MEGOHMS
- 2-3:DIELECTRIC WITHSTANDING VOLTAGE:
30V AC MIN;
- 3:MECHANICAL CHARACTERISTICS:
- 3-1:MATING FORCE:5~20N
- 3-2:UNMATING FORCE:8~20N(INITIAL),
6~20N(AFTER 10000 CYCLES)
- 3-3:FREQUENCY: 200±50 CYCLES /HOUR,10000 CYCLES
- 3-4:OPERATING TEMPERATURE ;-40~80°.
- 4: WATERPROOF: IP-X7.

| | | | |
|-----|-------------|-----|-------------|
| A1 | GND | B12 | GND |
| A4 | VBUS | B9 | VBUS |
| A5 | CC1 | B8 | SBU2 |
| A6 | DP1 | B7 | DN2 |
| A7 | DN1 | B6 | DP2 |
| A8 | SBU1 | B5 | CC2 |
| A9 | VBUS | B4 | VBUS |
| A12 | GND | B1 | GND |
| PIN | SIGNAL NAME | PIN | SIGNAL NAME |

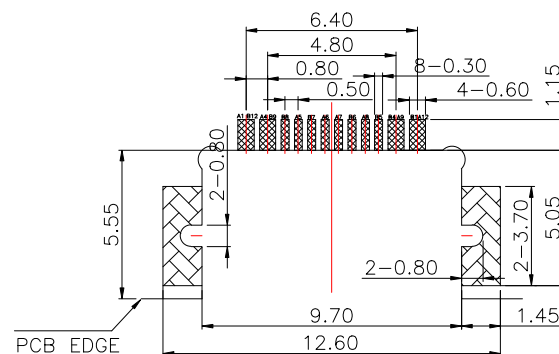
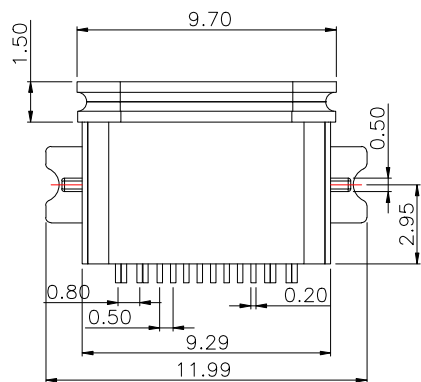
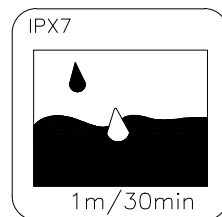
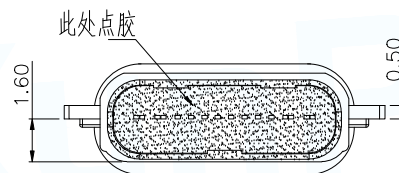
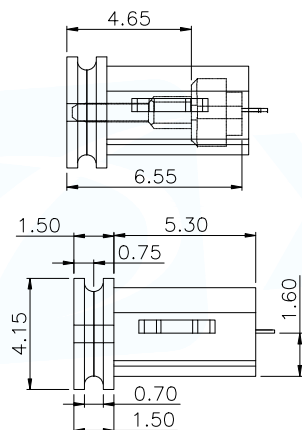
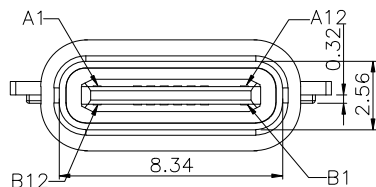

RECOMMENDED P.C.B. LAYOUT
TOLERANCE UNSPECIFIED ±0.05mm

| | | | | |
|---------------------------------------|-----------|----------|------------------------------|-----------------------|
| MANUFACTURE DWG | | | | |
| UNLESS OTHERWISE SPECIFIED TOLERANCES | | | TITLE:TYPE-C 16pin 沉板1.6压铸防水 | |
| DECIMALS: | ANGLES: | | PAR | TYPEC-318-ARP16X7SC16 |
| .X:±0.20 | X':±2° | | DWN | |
| .XX:±0.15 | .X':±0.5° | | CHKD | |
| .XXX:±0.05 | | APVD | | |
| CUSTOMER COPY | | SCALE1:1 | UNIT:MM | |
| | | SIZE:A4 | SHEET:1F1 | REV:A |

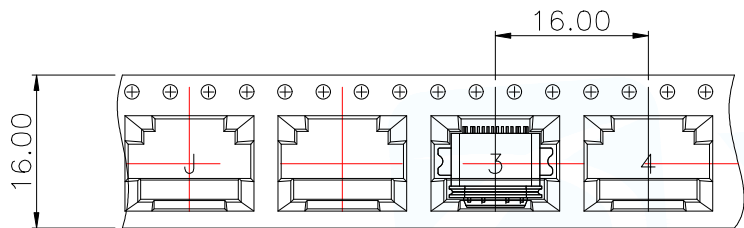
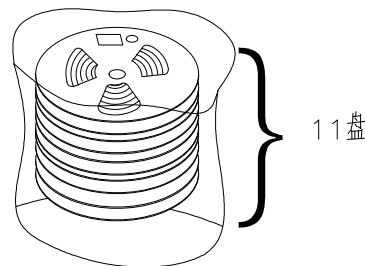
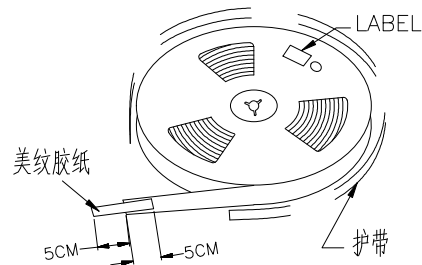
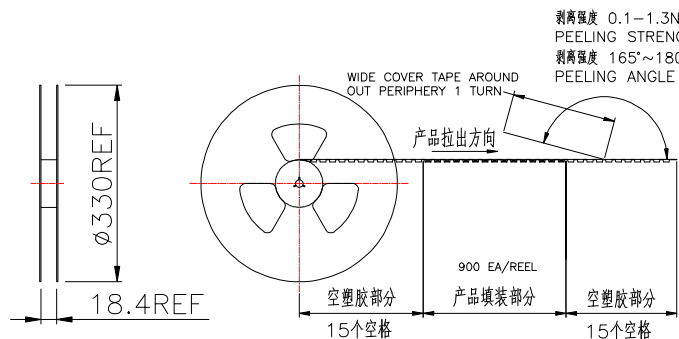

出盘方向

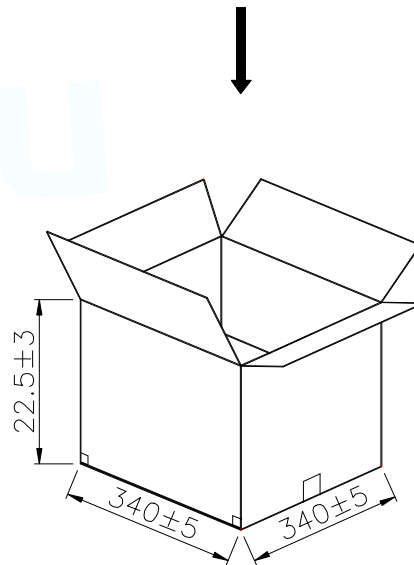
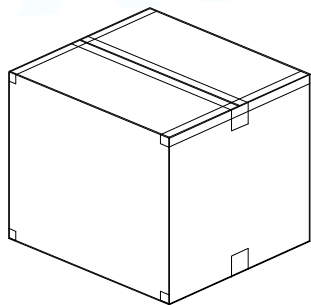

说明:

1. 将检查合格的产品,放入承载带中,一盘包装900/PCS
2. 将11承载带放入纸箱中;
3. 将纸箱封装好,贴上标签.

| | | |
|---------|--------|--------|
| 每箱数量 | 净重(Kg) | 毛重(Kg) |
| 9900PCS | xxx | xxx |

| | | | | |
|---------------------------------------|-----------|----------|---|-------|
| MANUFACTURE DWG | | | 东莞市讯普电子科技有限公司 DongGuan XunPu Electronics Co.,Ltd | |
| UNLESS OTHERWISE SPECIFIED TOLERANCES | | | TITLE:TYPE-C 16pin 沉板1.6压铸防水 | |
| DECIMALS: | ANGLES: | PAR | TYPEC-318-ARP16X7SC16 | |
| .X:±0.20 | X':±2° | DWN | | |
| .XX:±0.15 | .X':±0.5° | CHKD | | |
| .XXX:±0.05 | | APVD | | |
| CUSTOMER COPY | | SCALE1:1 | UNIT:MM | ⊕ |
| | | SIZE:A4 | SHEET:1F1 | REV:A |